

Product Overview

Chest Strap

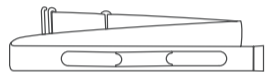

Heart Rate Sensor (battery included)



User Manual



Disclaimer

The information contained in this manual is for reference only. The product described may be subject to alteration owing to the manufacturer's continuing research and development plans, without making an announcement in advance. We shall not make any statement or warranty about this manual or the contained product. We shall not bear any legal responsibility for any direct or indirect, accidental or special damages, losses and expenses arising from or in connection with this manual or the contained product.

W.A.S.P.

For more information visit www.thewaspworks.com

W.A.S.P.

Heart Rate Sensor User Manual



W.A.S.P.

Heart Rate Sensor User Manual

Congratulations on purchasing our W.A.S.P. Heart Rate Sensor. This device supports both Bluetooth LE 4.0 and ANT+ real-time monitoring of heart rate. Information is transmitted wirelessly from the sensor to your smart phone app or sports watch. This user manual will help you to use the product better, please keep it for reference.



IMPORTANT: Please note that this product is for sport purposes only and it is not meant as a replacement for any medical device.

Battery

This device comes with a CR2032 battery already installed.

Battery replacement

Using a coin, twist the battery door counter clockwise until it clicks out of place.

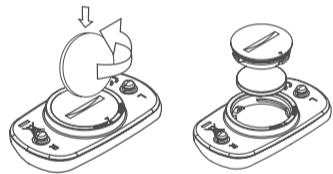

Remove the battery and replace with (+) side up. Use a coin to twist the battery door back into place clockwise.



Keep batteries away from children. Dispose of used battery according to local regulations.

How to use the Heart Rate Sensor

Moisten the electrode areas of the chest strap;



Attach the connector to the chest strap, marked 'L' towards left.

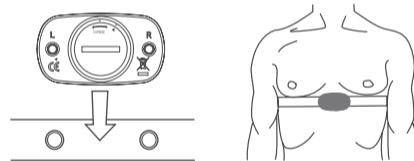

Adjust the strap length to fit tightly but comfortably. Check that the moist electrode areas are firmly against your skin.

Caring for your device

Please follow these caring instructions to ensure reliable operation of the heart rate sensor and to maximize life span.

Heart Rate Sensor

Detach the sensor from the strap after every use and dry with a soft towel. Do not use cleaning chemicals.

Chest strap

Rinse the strap under running water after every use and hang to dry. Cleaning of strap in a washing machine or dryer is **not** recommended.

- Never use cleaning chemicals. (Chemicals may cause premature aging and shorten service life).
- Do not stretch the strap or bend the electrode areas sharply.
- Storing of the sensor when wet may cause snap oxidation. Please store the strap and sensor when dry.

Heart Rate Sensor Specifications

| | |
|-------------------|-------------------------------|
| Measurement Range | 30-240 BPM |
| Adjustable Strap | L: 65-95 cm |
| Communication | Bluetooth 4.0, 10 m: ANT+, 6m |
| Battery Life | 800 hours |
| Waterproof grade | IP67 |
| Product size | 59.5 x 33.5 x 10.5 mm |
| Weight | 55 g |

Specifications are subject to change without notice.

Compatibility



Any Bluetooth 4.0 enabled Android device with Android 4.4 or later.

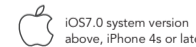

iOS7.0 system version above, iPhone 4s or later.



For compatible ANT+ devices that support the Heart Rate Profile (HRP), please go to <https://www.thisisant.com/directory>.

Compatible with most popular apps such as MooFit/Endomondo/Strava/Sports Tracker/Runtastic/Wahoo Fitness/WASP