

## Product Overview

1 x Speed/cadence Sensor



2 x Band (large, small)



2 x Rubber mat (flat, curved)

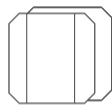

User Manual



## Caring for your device

Please follow these caring instructions to ensure reliable operation of the cycle cadence sensor and to maximize life span. Detach the sensor from the bike after use, and clean and dry with a soft towel. Do not use cleaning chemicals.

### Disclaimer

The information contained in this manual is for reference only. The product described may be subject to alteration owing to the manufacturer's continuing research and development plans, without making an announcement in advance. We shall not make any statement or warranty about this manual or the contained product. We shall not bear any legal responsibility for any direct or indirect, accidental or special damages, losses and expenses arising from or in connection with this manual or the contained product.

# WASP

For more information visit [www.thewaspworks.com](http://www.thewaspworks.com)

# WASP

## Cycle Cadence Sensor User Manual



# WASP

## Cycle Cadence Sensor User Manual

Congratulations on purchasing our WASP cycle cadence sensor. This device supports both Bluetooth LE 4.0 and ANT+ real-time monitoring of cadence. Information is transmitted wirelessly from the sensor to your smart phone app or sports watch. This user manual will help you to use the product better, so please keep it for reference.

## Battery

This device comes with a CR2032 battery already installed.

### Battery replacement

Using a coin, twist the battery door counter clockwise until it clicks out of place.



Take out the insulating sheet



Keep batteries away from children. Dispose of used battery according to local regulations.



## Function and operation

This product has two modes of operation, cadence or speed monitoring. The mode switches from speed to cadence monitoring and back each time the battery is removed and replaced. After inserting the battery, a light on the front of the product will glow either red or blue for a few seconds.

### Mode switching

Twist the battery door with a coin in the OPEN direction, open the battery door, remove the battery and then re-insert the battery again. Close the battery door by twisting in the CLOSE direction.

After the battery is re-inserted there will be a light on.

RED indicates speed mode

BLUE indicates cadence mode

## Installation for cadence mode

Buckle the flat rubber mat onto the back of the sensor, then bind the sensor with the large rubber band onto the pedal crank.

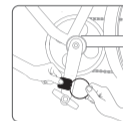

## Installation for speed mode

Buckle the curved rubber mat onto the back of the sensor, then bind the sensor with the large rubber band onto the wheel axle.

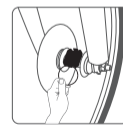

## Cycle cadence sensor specifications

|                     |   |
|---------------------|---|
| Measurement Range   | 300rpm (or 120km/h for speed)                           |
| Working temperature | -20 + 60  |
| Communication       | Bluetooth LE 20m: ANT+ 10m                              |
| Battery Life        | 300 hours for cadence mode<br>500 hours for speed mode. |
| Waterproof grade    | IP67  |
| Product size        | 36 x 30 x 13.8 mm                                       |
| Weight              | 9g  |

Specifications are subject to change without notice.

## Compatibility



Any Bluetooth 4.0 enabled Android device with Android 4.4 or later.



For compatible ANT+ devices that support the Heart Rate Profile (HRP), please go to <https://www.thisisant.com/directory>.



iOS7.0 system version above, iPhone 4s or later.

Compatible with most popular apps such as MooFit/Endomondo/Strava/Sports Tracker/Runtastic/Wahoo Fitness/WASP